

Ex. A Match the following sentences

(1x5=5 marks)

1	Tomorrow the weather		so that your bones grow strong.
2	You should visit the dentist		many sweets and sugar.
3	You should drink lots of milk	1	will be sunny and hot.
4	We must put rubbish in the		your hands before meals.
5	You mustn't eat too		bin so that we keep our village clean.
6	You must wash		twice a year.

Ex. B Turn the verbs in the brackets in the Past Tense and fill in

(1x5=5 marks)



Last year Lisa (is) was in Year 4. She (has) \_\_\_\_\_ problems with her eyesight. She could not see the whiteboard from behind so she (ask) \_\_\_\_\_ the teacher to put her in the front row. Lisa (do) \_\_\_\_\_ not want to tell her mother about her problem. She only (tell) \_\_\_\_\_ her friend Emily. Emily (advise) \_\_\_\_\_ her to tell her parents but Lisa refused.

Ex. C Fill in with these words

(1 x 10=10 marks)

<del>school</del>	together	paintbrush	First	puppet	draws
cuts	must	mustn't	scissors	careful	

At school Susie is making a \_\_\_\_\_.



she \_\_\_\_\_ the puppet.

Then she \_\_\_\_\_ out the

pieces. Susie \_\_\_\_\_ be

very \_\_\_\_\_ when using

the \_\_\_\_\_.

After that she sticks the parts \_\_\_\_\_.

Finally Susie paints the puppet with a \_\_\_\_\_.

She \_\_\_\_\_ drop the puppet!



Ex. D The children are at school. How can they find the right place from the main entrance? Look at the diagram below and continue the dialogue.

(2x2½ =5 marks)

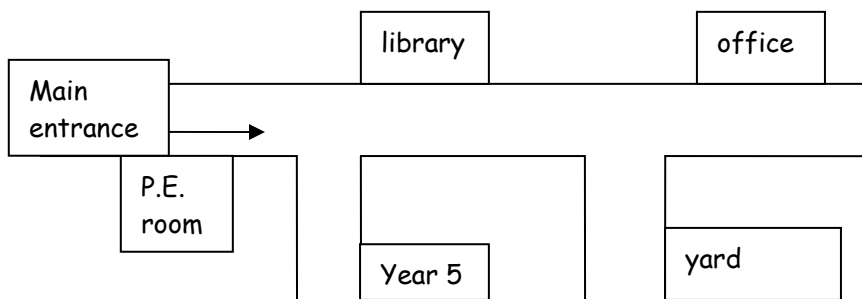

Eg.

1. Excuse me, where's the Year 5 class please?

Walk straight along the corridor. Turn first right and the Year 5 class is on your left.

2. Excuse me, where's the library please?

---

---

3. Excuse me, where's the yard please?

---

---

Ex. E Look at the advert below and then fill in the spaces

(1x10=10 marks)

### The New Fantasy Clinic

...where you find a doctor, a nurse and a dentist.

Open:                    Monday, Wednesday, Friday  
                                  8.00am --- 11.00am  
                                  1.00pm --- 6.00pm

Phone 21334718 for an appointment or email [fantasyclinic@mail.com](mailto:fantasyclinic@mail.com)

Visit our website:

[www.fantasyclinic.com](http://www.fantasyclinic.com)



This is the New Fantasy Clinic. The clinic is open on Monday, \_\_\_\_\_ and \_\_\_\_\_. The New Fantasy Clinic opens at 8.00am and \_\_\_\_\_ at 11.00 in the \_\_\_\_\_. It opens again in the afternoon from 1.00pm \_\_\_\_\_ 6.00pm. At this clinic you can find a \_\_\_\_\_, a dentist and a \_\_\_\_\_. You may phone or send an email for an \_\_\_\_\_. To take a look at all the \_\_\_\_\_ you can \_\_\_\_\_ the website.

Ex. F

1. Tick (✓) the box to show whether the answer is True or False  
(3 × 1 = 3 marks)

		True	False
a)	<b>Example. Lisa was in Year 5</b>	✓	
b)	Lisa was worried because of her eyesight.		
c)	Her mother took her to see a dentist.		
d)	Lisa was happy to have new glasses.		

2. Fill in the blanks with one word only from the text  
(3 × 1 = 3 marks)

**Example: At first Lisa did not really know what was happening.**

- a) She kept her glasses in her \_\_\_\_\_.  
b) During breaktime Emily lost her \_\_\_\_\_.  
c) The finger puppet was found on the \_\_\_\_\_.

3. Underline the correct answer. (4 × 1 = 4 marks)

- a) Before she got her glasses Lisa could not see the whiteboard  
(at all, not so well, clearly).
- b) The doctor instructed her to wear glasses (sometimes, in the morning, all the time).
- c) Her mother decided to take her to check her eyesight the  
(next week, next day, next month).
- d) When she put on her glasses, everything looked (the same, so different, so misty).

4. Match the word to the correct meaning. (3 × 1 = 3 marks)

a)	fuzziness (para 1)		wary
b)	suspicious (para 2)		not clear
c)	<b>miserable (para 4)</b>		shine
d)	glimmer (para 5)	<b>c</b>	<b>sad</b>

- Now Answer these questions in full answers (6 × 2 = 12 marks)

5. Why was Lisa feeling so worried?

---

6. Why did her mother decide to have Lisa's eyesight checked?

---

7. Give a reason why Lisa kept her glasses in her pocket?

---

8. Find a word from the passage that means 'to look with half-shut eyes'.

---

9. What made Lisa decide to help Emily?

---

10. What did you learn from this story?

---

Ex. 6 COMPOSITION

(25 marks)

Write a composition of about 120 words about one (1) of the following.

1. If I were a soft, comfy sofa.  
*(Think of yourself as a comfortable sofa. Write about how you would feel about the different people whom you meet. Talk about whether you enjoy your life and why.)*
  
2. Send an e-mail to Ms Carter, the Assistant Head of your school. You are annoyed about the neglectful state of the school garden as well as the littering that is going on in your school.
  
3.  
*(Write a story ending with the following words).*  
.....that was the worst day of my life. I wish I had never decided to go out that morning!
  
4. Picture Story  
Look at the pictures on the separate sheet and write a story about them. **Give your own title.** (These words may help you: recipe, ingredients, rolling pin, dough, cup cakes, baking tray, oven, snooze, smoke, frustrated)

---

---

---

---

---

---

---

---

---

---





